

Massa Carrara - Italy



Cernusco sul Naviglio - Milan (Italy)



Housing: in extruded aluminium, cylindrical section.

Cap: made of die-cast aluminium.

Painting: in several stages. First stage: epoxy cationic electrocoating, resistant to corrosive and saline environments. Second stage: UV-stabilising primer, and final stage rough finish with graphite acrylic coating(it has passed the UNI ISO 9227 1000 hr test).

Electric gear: 230V/50 Hz power supply. Hard wire 0.50 sqmm cross-section (FLC) and PVC-HT sheath, or silicone wire terminated with quick connect clamps in admiralty brass, with fibreglass braid, 1.0 sqmm cross-section. 2P+T terminal block with maximum allowed lead cross-section of 4 sqmm.

Standard supply: with steel flange to be embedded in the ground with power cable passing through the lower part. Support in die-cast aluminium for wall mounting. Electric gear on removable tray for easy maintenance.

SAP-E 70: supplied with lamps with built-in igniter.

Flange to be embedded in the ground with power cable passing through the lower part. Support in die-cast aluminium for wall mounting. Electric gear on removable tray for easy maintenance.

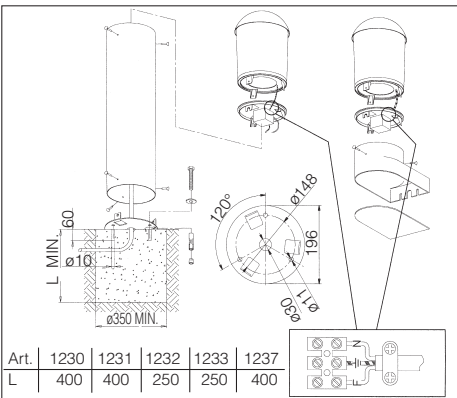

ZONA 1

1237 - MBF 80

MBF E27

FLC-L

2G11

SAP-E E27

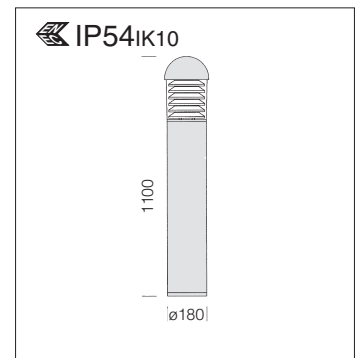

Diffuser: In polycarbonate, clear vandal resistant and V2 self-extinguishing, UV-stabilised.

Louvre: LIGHT POLLUTION PREVENTING SYSTEM with black colour louvre.

1237 Faro - high version						
		CNR		CNRL		Lamps (Ta=25°C)
wattage	colour	weight	code	weight	code	Kelvin - olm - Ra
MBF 80	s. silver	7.10	510047-00			
SAP-E 70	s. silver	7.10	510050-00			
FLC 2x18L	s. silver			6.30	510048-00	3000K - 1200lm - Ra 1b

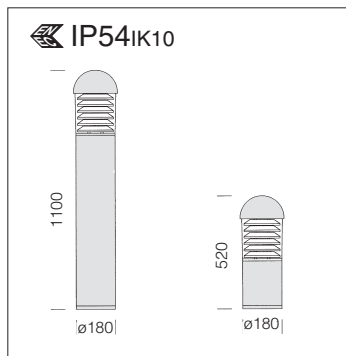

Diffuser: In polycarbonate, or clear vandal resistant and V2 self-extinguishing, UV-stabilised.

Louvre: in matt aluminium.

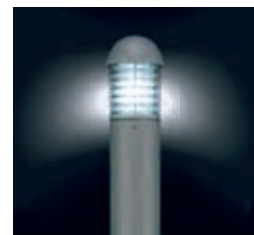
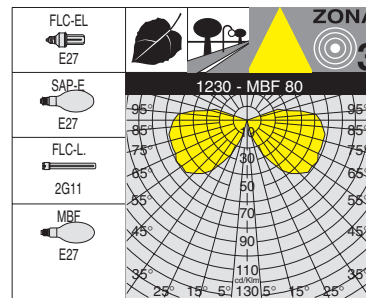

1230 Faro - high version								
		S		CNR		CNRL		Lamps (Ta=25°C)
wattage	colour	weight	code	weight	code	weight	code	Kelvin - ølm - Ra
MAX 75	graphite	6.00	510003-00					
MBF 80	graphite			7.10	510037-00			
SAP-E 70	graphite			7.10	510038-00			
MBF 80	s. silver			7.10	510040-00			
SAP-E 70	s. silver			7.10	510041-00			
FLC 2x18L	graphite					6.30	510039-00	3000K - 1200lm - Ra 1b
FLC 2x18L	s. silver					6.30	510036-00	

1232 Faro - short version								
		S		CNR		CNRL		Lamps (Ta=25°C)
wattage	colour	weight	code	weight	code	weight	code	Kelvin - ølm - Ra
MAX 75	graphite	3.05	510203-00					
MBF 80	graphite			4.15	510237-00			
SAP-E 70	graphite			4.15	510238-00			
FLC 2x18L	graphite					4.80	510239-00	3000K - 1200lm - Ra 1b

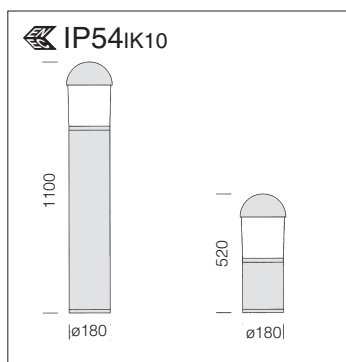

Diffuser: In polycarbonate, opal vandal resistant and V2 self-extinguishing, UV-stabilised.

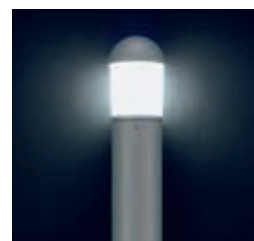
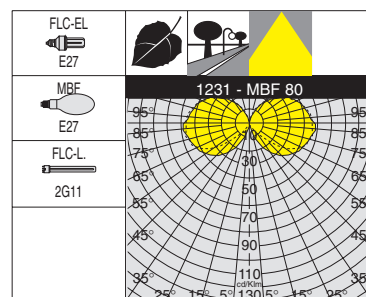
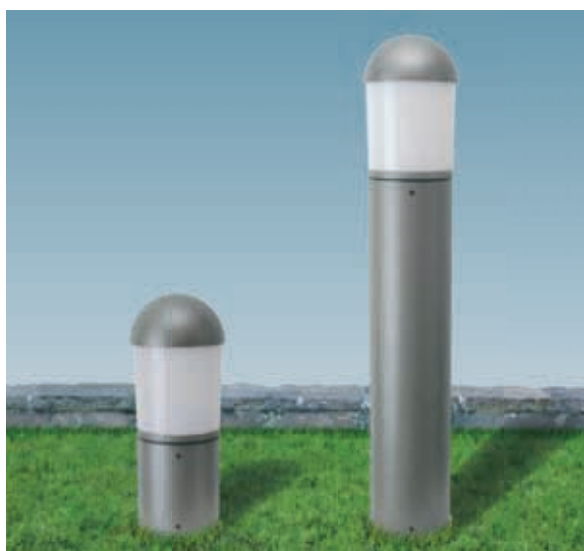

1231 Faro - high version								
		S		CNR		CNRL		Lamps (Ta=25°C)
wattage	colour	weight	code	weight	code	weight	code	Kelvin - ølm - Ra
MAX 75	graphite	5.60	510103-00					
MBF 80	graphite			6.70	510137-00			
FLC 2x18L	graphite					5.70	510139-00	3000K - 1200lm - Ra 1b

1233 Faro - short version								
		S		CNR		CNRL		Lamps (Ta=25°C)
wattage	colour	weight	code	weight	code	weight	code	Kelvin - ølm - Ra
MAX 75	graphite	2.65	510303-00					
MBF 80	graphite			3.75	510337-00			
FLC 2x18L	graphite					4.20	510339-00	3000K - 1200lm - Ra 1b

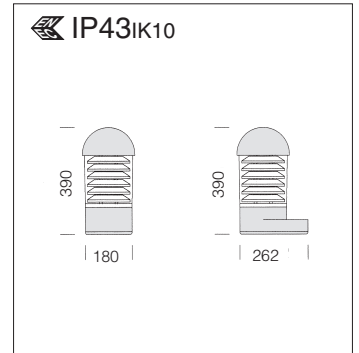
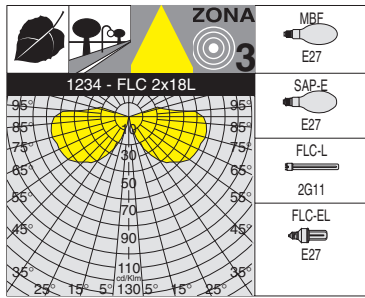

Diffuser : in polycarbonate, clear vandal resistant and V2 self-extinguishing, UV-stabilised.

Louvre: in matt aluminium.

1234 Faro - wall version								
		S		CNR		CNRL		Lamps (Ta=25°C)
wattage	colour	weight	code	weight	code	weight	code	Kelvin - ølm - Ra
MAX 75	graphite	3.10	510403-00					
MBF 80	graphite			4.20	510437-00			
SAP-E 70	graphite			4.20	510439-00			
FLC 2x18L	graphite					4.20	510401-00	3000K - 1200lm - Ra 1b

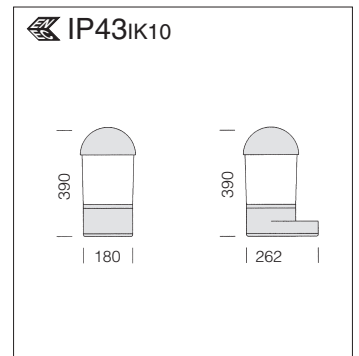
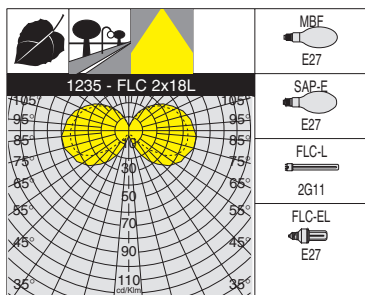

Diffuser : in polycarbonate, opal vandal resistant and V2 self-extinguishing, UV-stabilised.

1235 Faro - wall version								
		S		CNR		CNRL		Lamps (Ta=25°C)
wattage	colour	weight	code	weight	code	weight	code	Kelvin - ølm - Ra
MAX 75	graphite	2.70	510503-00					
MBF 80	graphite			3.80	510537-00			
FLC 2x18L	graphite					3.60	510539-00	3000K - 1200lm

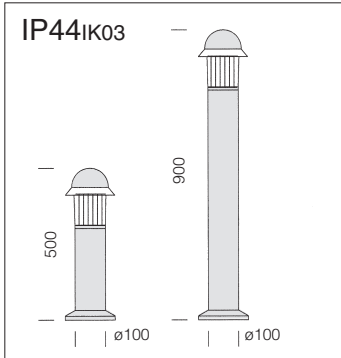

Housing: In extruded aluminium, cylindrical section.

Cap: in die-cast aluminium.

Diffuser : in polycarbonate, clear frosted vandal resistant and V2 self-extinguishing, UV-stabilised.

Painting: In several stages. First stage: epoxy cationic electrocoating, resistant to corrosive and saline environments. Second stage: UV-stabilising primer, and final stage rough finish with graphite acrylic coating(it has passed the UNI ISO 9227 1000 hr test).

Electric gear: 230V/50 Hz power supply. Hard wire 0.50 sqmm cross-section. 2P+T terminal block with maximum allowed lead cross-section of 4 sqmm.

Standard supply: With steel flange to be embedded in the ground.

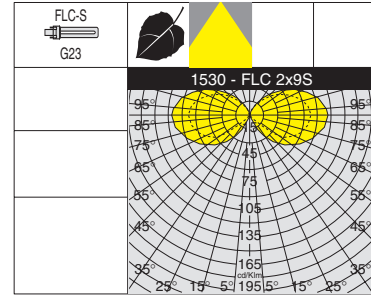

1530 Faro2 scored diffuser - high version				
		CNL		Lamps (Ta=25°C)
wattage	colour	weight	code	Kelvin - ølm - Ra
FLC 2x9S	graphite	2.95	510053-00	4000 K - 600 lm - Ra 1b

1532 Faro2 scored diffuser - short version				
		CNL		Lamps (Ta=25°C)
wattage	colour	weight	code	Kelvin - ølm - Ra
FLC 2x9S	graphite	2.24	510253-00	4000K - 600lm - Ra 1b

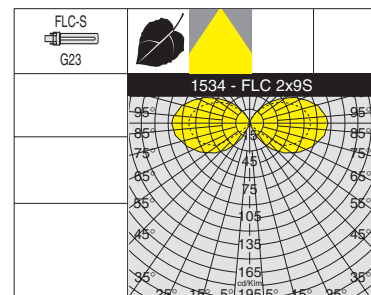
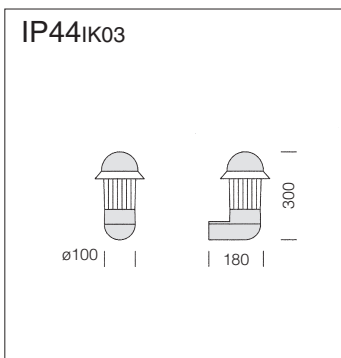

1534 Faro2 scored diffuser - wall version				
		CNL		Lamps (Ta=25°C)
wattage	colour	weight	code	Kelvin - ølm - Ra
FLC 2x9S	graphite	1.39	510453-00	4000K - 600lm - Ra 1b

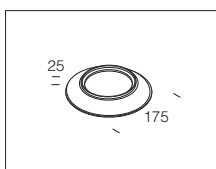

acc. 78 ring	
red	985021
green	985022
yellow	985023
white	985024
In coloured plexiglass.	

